

SuperLoader™ Drive Carrier Assembly (DCA) Replacement Quick Start Guide

This Quick Start Guide gives the steps for replacing the drive carrier assembly (DCA) of a Quantum SuperLoader.

These instructions are for both the SuperLoader DLT™ (which includes the SuperLoader SDLT) and SuperLoader LTO due to the nature of their similarities. In general, the SuperLoader DLT is used in the illustrations. Though the components are similar in appearance, many component parts are not interchangeable. These include the magazines, cartridges, drive carrier assembly, magazine blank, magazine handle, and the bar code reader.

For additional information, visit www.quantum.com, refer to the *Quantum Superloader Automated Tape Library User Manual* installed as a PDF (portable document format) file on the SuperLoader Documentation CD, or contact Quantum Technical Support and Customer Service by calling 1-800-284-5101.

Note: Adobe Acrobat Reader 4.0 or later is required to view and print PDF documents. To download a free copy of Adobe Acrobat Reader, go to www.adobe.com.

Step 1: Unpack the DCA

- a. Look for markings on the shipping carton that indicate the top. If necessary, position the carton so that it is right-side up.
- b. Using scissors, a utility knife, or other appropriate tool, carefully cut the packing tape along the length and ends of the carton.
- c. Fold open the box flaps.
- d. Remove the plastic bag containing installation hardware (four screws).
- e. Reach into the carton with both hands, lift the DCA and its foam pads out of the box, and place the DCA on a flat work surface.
- f. Rotate the DCA so that one foam pad is against the work surface and the other is above the DCA.
- g. Remove the exposed foam pad from the DCA.
- h. Rotate the DCA so that the other foam pad is up. Remove the foam pad.

The DCA should still be inside antistatic packaging.

Caution: This device is static-sensitive. Proper grounding and electrostatic discharge (ESD) handling precautions are required before removing the DCA from its packaging. These precautions include unpacking the DCA in a static-free work area and using an antistatic wrist band as well as other antistatic apparel.

- i. Set the DCA down on the work surface.

Step 2: Prepare for Removal and Replacement

Caution: Do not apply power to the DCA unless the DCA is fully installed in the SuperLoader and secured by all four mounting screws.

- a. Make sure you have the following tools:
 - #2 PHILLIPS® screwdriver
- b. Take appropriate ESD precautions. Leave the replacement DCA in its antistatic packaging until you are ready to install it.

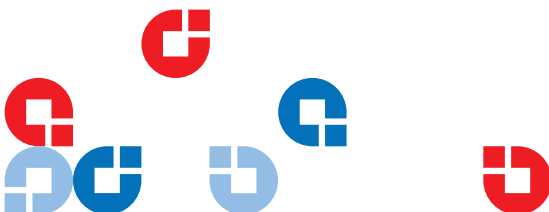

Step 3: Remove the Current DCA

Note: Before you remove the DCA, make sure the tape drive does not contain a tape cartridge. For instructions about unloading a cartridge from the tape drive, refer to the User's Guide.

- Turn off the SuperLoader using the front panel button.
- Disconnect all cables from the back of the DCA.
- Remove the four screws that secure the DCA to the chassis at the rear of the SuperLoader.

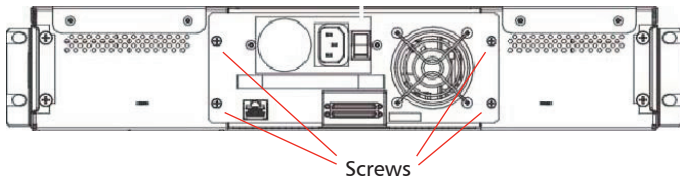

Caution: While removing or handling the SuperLoader DLT DCA, do not touch the exposed printed circuit board assembly on the underside of the unit.

- With one hand, grasp the DCA handle and slide the DCA out while supporting it from underneath with your other hand.

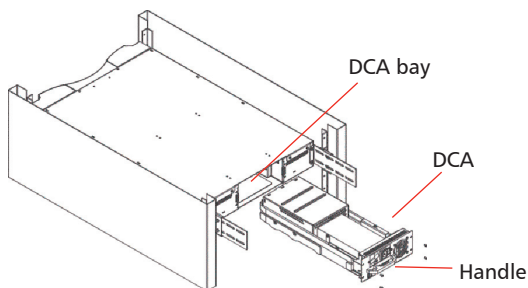

- Set aside the DCA you just removed.

Note: The DCA must be returned to Quantum in the replacement DCA packaging within 7 business days. For further information, refer to the return material authorization (RMA) instructions shipped with the replacement DCA.

Step 4: Install the Replacement DCA

Caution: While removing or handling the SuperLoader DLT DCA, take appropriate ESD precautions to prevent accidentally touching or damaging the exposed printed circuit board assembly on the underside of the unit.

- Remove the replacement DCA from its antistatic packaging.
- Grasp the DCA by the handle with one hand and support the underside of the DCA with the other hand.
- Slide the DCA into the DCA bay. Make sure you position the DCA correctly; it should slide smoothly into the bay.
- Install the four screws (included with the replacement DCA) to secure the DCA to the SuperLoader chassis. Tighten the screws firmly.
- Make sure that the AC power switch on the back of the DCA is off. Then, connect the power and SCSI cables.
- Turn on the SuperLoader by pressing the AC power switch at the back of the unit. Verify that the SuperLoader is operating properly.

Note: On all SuperLoaders, SCSI terminators must be used for proper operation of the drive.

For more information,
visit our Web site at
www.quantum.com

United States of America
Quantum Corporation
Storage Solutions Group
141 Innovation Drive
Irvine, CA 92612
U.S.A.
phone 949.856.7800
fax 949.856.7799

Europe
7 Lindenwood
Chineham Business Park
Basingstoke, RG24 8QY
United Kingdom
phone +44 1256 818300
fax +44 1256 848700

Asia Pacific
Level 3
200 Creek Street
Brisbane, Qld 4000
Australia
phone +61 7 3839 0950
fax +61 7 3839 0955